

LED MR16 TRI-CCT GLOBE (6W)

- Input voltage: 12V AC/DC
- Diffuser: plastic clear
- Housing: plastic & aluminium
- Heatsink: PBT
- LED chips: 10pcs SMD2835
- Tri-CCT (3000K/ 4000K/ 5000K)
- CCT switch on housing
- CRI: ≥80
- Power factor: ≥0.5
- Ambient temperature: -20 to 40°C
- Not suitable for dimming
- Suitable for 2 way switching
- Suitable for use with sensors

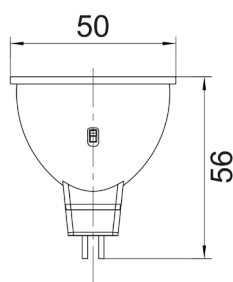

LED Globes

Part No.	Description	Lumens			Watt	Size	Box Weight	Box Size	Carton QTY
		3000K	4000K	5000K					
MR16TRI1	GLOBE LED MR16 6W TRI	432lm	495lm	605lm	6W	Ø50x56mm	0.05kg	5x5x6cm	1/10/100

Recommended Control Gears:

BRAND	PART NO.	TYPE	IP RATING
LUXMAN	ETH50.302VA (50W)	Transformer	IP65
CLA	CLADR12W	LED Driver (Constant Voltage)	IP20
CLA	DRIV1	LED Driver (Constant Voltage)	IP20
CLA	OTTER1	LED Driver (Constant Voltage)	IP67
CLA	CLA111011	LED Driver (Constant Voltage)	IP67
CLA	CLA113011	LED Driver (Constant Voltage)	IP67
CLA	CLA115011	LED Driver (Constant Voltage)	IP67
CLA	CLA1110011	LED Driver (Constant Voltage)	IP67
CLA	OTTER5	LED Driver (Constant Voltage)	IP67
CLA	CLA1120011	LED Driver (Constant Voltage)	IP67
CLA	OTTER7	LED Driver (Constant Voltage)	IP67